



# 380 SERIES

## General Purpose Single Seal

Advanced Sealing International



The **380 Series**, ASI's entry level mechanical seal line, is designed for general purpose applications and ideally suited for ANSI pump package projects. Comprised of two basic seal designs, the **Model 380** and the **Model 385**, the 380 series provides flexible pricing and stocking options to suit varying customer needs and project requirements.

# ASI 380 Series Seals

The 380 series' simple yet rugged rotary design provides reliable service with fewer parts to fail or add cost to the seal. Available with a standardized gland plate for stocking purposes (the Model 385) or a pump-specific format for large quantity projects (the Model 380), each seal delivers an unsurpassed "bang for your buck" factor, all backed with the quality and performance the **ASI** seal name has come to represent.

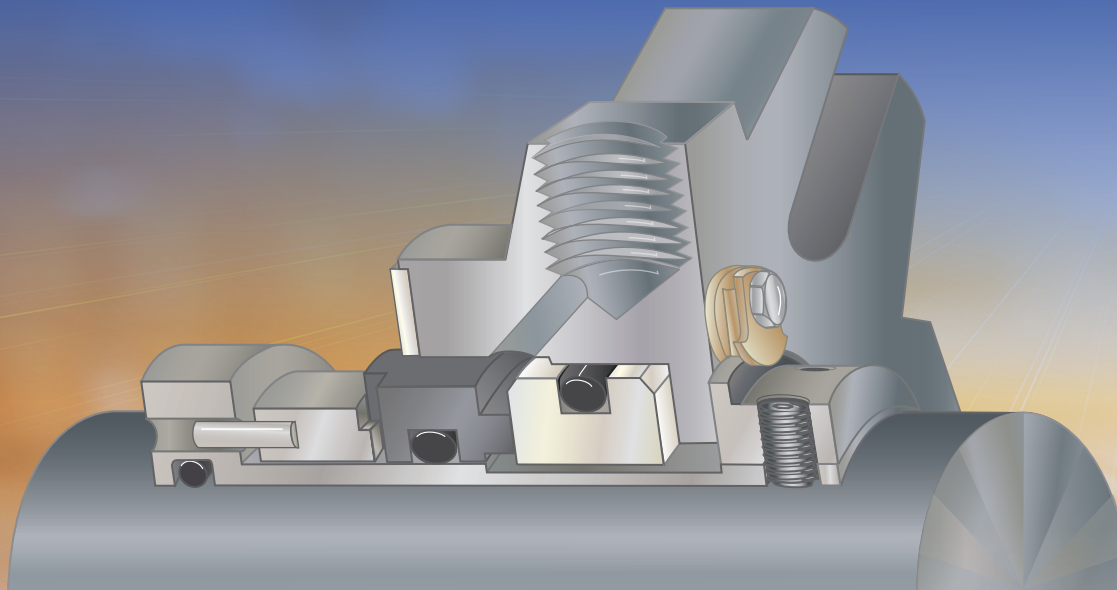

## The Model 380

### Pump Specific Gland Plate

The **380's** custom gland plate is built to fit specific equipment and can be supplied with (or without) desired design features to accommodate individual project requirements.

### Project Specific Pricing Minimum Quantity Requirements

All **380** seals are priced based on requested seal configuration and purchase quantity. This ensures the best possible price for each project while providing the flexibility to change configurations as required.

### Materials of Construction:

#### METAL PARTS

316ss; Standard Springs- Hastelloy® C;  
Standard Set Screws- 316ss

#### FACE MATERIALS

Stationary Face- Silicon Carbide; Rotary Face-  
Carbon Graphite or Silicon Carbide

#### SECONDARY SEALS

Standard O-ring Materials- Aflas®

## The Model 385

### Universal Gland Plate

The **385's** gland plate is designed with a slotted bolting configuration to accommodate varying ANSI size pumps. In addition, all **385** seals are equipped with a flush inlet.

### Fixed Pricing No Quantity Requirements

The **385** is sold in any requested quantity (without purchase minimums or stocking requirements). The **385's** uniformity of design allows for highly competitive, fixed pricing with little or no initial investment costs.

### Additional Features:

#### HANDY-CAM™ ASSEMBLY DEVICE

Protects against installation damage with the ease of one-step disengagement. Aligns and protects the seal both axially and radially.

#### SAFE-T-STUD (Patent # 5,275,421)

ASI's unique drive mechanism aids in precision alignment and transmits torque without causing set screw damage typical to most seals.